

PART NO 1

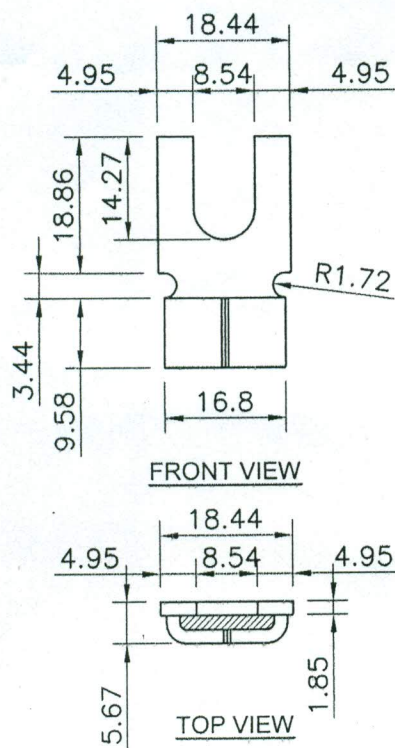

PART NO 2

TYPE : BE 22Z1
FRAME SIZE : TPR 450 E



URANIUM CORPORATION OF INDIA LTD. TURAMDHIH MILL
(A GOVT. OF INDIA ENTERPRISE, DEPT. OF ATOMIC ENERGY)

DRN. Rajesh 21.09.13

CHECKED D.P. Singh

APPROVED G. DHAR

SCALE - N.T.S.

DIMENSIONS IN MM

TITLE

CARBON BRUSH FOR 260 KW / 650 KV

6.6 KV SLIPRING MOTOR

DRG.NO.- MILL/TMD/ELECT.-18

REV.-0

Name Plate Specification for 260 KW, 6600 Volt, 3 phase, Slip Ring Induction Motor

Make - Crompton Greaves

KW (H.P): 260 (348)

IS: 325 : 1996

RPM: 1480

Frame: TPR 355 D

Ins. Class: F

Enclosure: CACA (IPW 55),

M/C No: 2004017 / 2

Freq: 50 Hz

Weight: 3300 Kg

Volts: 6600

Amp: 29

Rv: 520 V

RA: 295 A

Amb: 50 °C

Alt: 1000 m

Duty: S1

Rating MCR GD² (Motor): 36 Kg m²

Full load Efficiency: 89.00%

Bearing (DE): NU221 C3

NDE: NU 6321 C3

Lubricant: Servogen 2 of IOC or Equivalent

Relubrication: DE 3000 Hrs
NDE 5000 Hrs

Ray